

25-539

Wm Brown to Marystown Dec. 21-1895, P.H. OCS.  
Inst. in following: Pt. Lot, 9. B. 19, P.H. OCS.  
Beg. 84. Ft. N. of S.E. Cor. sd Lot, - N- 38. Ft. W. 10 rods  
S 38. Ft. E. 10. rods to beg.

Surveyed Feb. 28<sup>th</sup> 1896.  
for R. McIntyre.

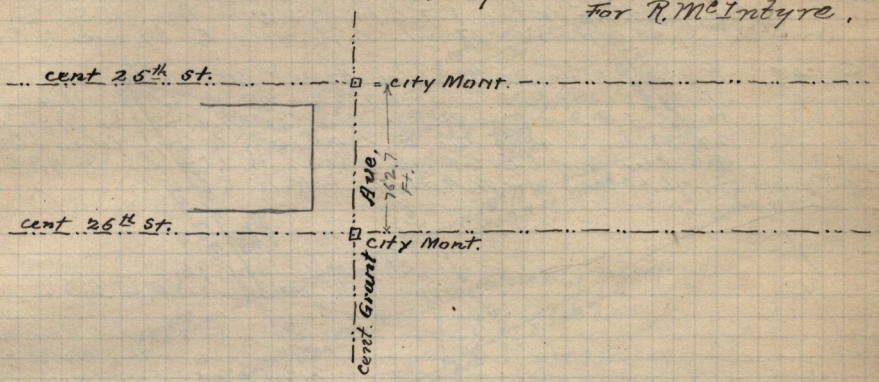

copy of abstract, 1<sup>st</sup> Pt. N.E. 1/4 Sec. 30 T.7. N. R.1. W. Prsg.  
11.75 chs. N. of N.E. Cor. ad. 1/4 Sec. - N. 19.65  
chs. S82°56'E. 3.14 chs. S. 7.91 chs. S. 77° E.  
15.05 chs. N 5°30' E. 7.35 chs. to beg.  
2<sup>nd</sup> Prsg. 475.2 ft W. + 890. ft S1° W, and 497.64  
ft. N 76°33' W. from the N.E. Cor. ad. 1/4 Sec.  
S. 1° W. 659.1 ft. - N 87°38' W 512.7 ft. N 1°05' E. 755.5  
to center of County Road, S 76°33' E 522.5 ft along  
center of rd. to beg

- S-176- Richard D. Person to Richard Hayes, Dec. 24-1884.  
Pt S.W. 1/4 Sec. 6. T.6. N. R.1. W. - Prsg. 23.40 chs. N. and 32.75  
S89°20' W. of S.E. Cor. ad. 1/4 Sec. - Run thence S02°17' W  
24.47 chs. thence S86°05' W. along S. line of ad. 1/4 Sec.  
10.63 chs. to S.W. cor. ad. 1/4 Sec. N. of 25.07 chs. N89°20' E  
10.78 chs. to beg.
- E. 113. Henry Dixon to Saml White, Apr. 25-1870. Pt S.E. 1/4 Sec. 1.  
T.6. N-R. 2. W. Prsg. S.E. Cor. ad. 1/4 Sec. N. 98 rods W.  
37 rods, S 98 rods, E 37 rods to beg.
- R. 596. Martin H. Harris & wife to Saml White - Feb. 3-1872.  
Pt. N.W. 1/4 Sec. 7. T.6. N. R.1. W. Prsg. N.W. cor. ad. 1/4 Sec.  
E. 7.22 chs. S 19.15 chs. W. 7.22 chs. N. 19.15 chs. to  
beg.
- H. 561. Saml White to Richard Hayes. - Oct. 29-1877  
Pt N. E. 1/4 Sec. 12. T.6. N. R. 2. W. - Beg. 570 chs. N. of  
N.E. Cor. ad. 1/4 Sec. - W. 4.04 chs. S 15.43 chs. in center of  
St. E. 9.53 chs. N 19° W. 16.40 chs. on W. line of  
C. P. R. R. to beg.
- M-82. Henry Dixon to Richard Hayes - Oct 22-1878.  
Pt S.E. 1/4 Sec. 1. T.6. N-R. 2. W. - Prsg. 10.40 chs. W. of S.E. cor.  
ad. 1/4 Sec. in center of St. - N 4.47 chs. - N 89°3/4° W. 24.37  
chs. S 4.55 chs. E 24.37 chs. to beg. Also - Prsg. 57.69 W.  
of S.E. Cor. ad. 1/4 Sec. N. 3.54 chs. N. 9.82 chs. - S 19° E.  
810.4° chs. along N. side C. P. R. R. to beg.